

Key	
	NEW TREES
	LOW LEVEL RAILINGS
	1800mm HIGH CLOSE BOARDED FENCE
	LOW LEVEL OPEN 3 RAIL FENCING
	EXISTING BUILDINGS TO BE DEMOLISHED

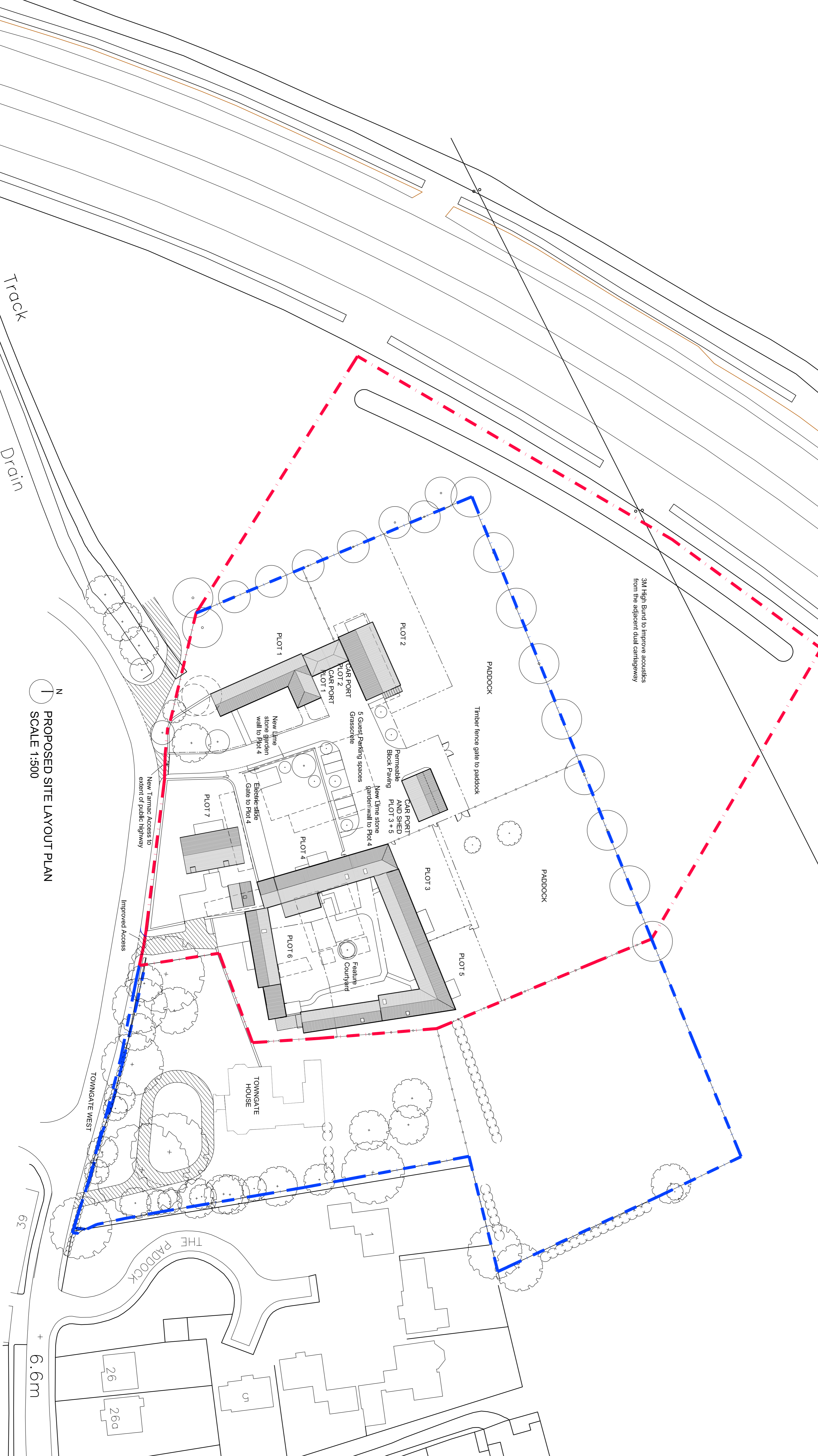

N
PROPOSED SITE LAYOUT PLAN
SCALE 1:500

Do not scale from this drawing
This contractor is to check all dimensions on site
All rights reserved in copyright © of the
copyright, design and content Act 1988
The copyright in this drawing is reserved

ACCOMMODATION SCHEDULE

Proposed Gross External Areas:
(Excluding Car Ports)

PLOT 1	372.8 m ²	2 Storey
PLOT 2	328 m ²	2 Storey
PLOT 3	242.3 m ²	2 Storey
PLOT 4	314.4 m ²	2 Storey
PLOT 5	242.5 m ²	1 Storey
PLOT 6	317.8 m ²	2 Storey
PLOT 7	284.4 m ²	2 Storey

E	12.02.11	Drawn: TJM	Check: TJM
D	26.10.10	Drawn: TJM	Check: TJM
C	29.09.10	Drawn: TJM	Check: TJM
B	11.08.10	Drawn: MV	Check: TJM
A	20.02.10	Drawn: MV	Check: TJM
-	08/04/10	Drawn: MV	Check: TJM

Initial Issue

Updates to Planning Application
A - 20.02.10 Drawn: MV Check: TJM
Updated as per meeting with client dated 15.05.10
- 08/04/10 Drawn: MV Check: TJM

Updates to Highways comments - quiet parking stream
C - 29.09.10 Drawn: TJM Check: TJM
Updates to planning comments
B - 11.08.10 Drawn: MV Check: TJM
Updates to planning comments
A - 20.02.10 Drawn: MV Check: TJM

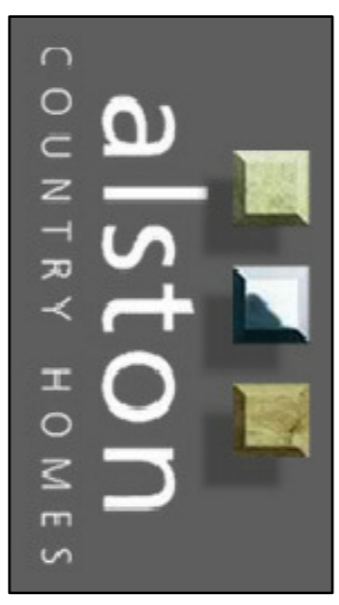

Address: Alston Country Homes Ltd
The Old Rectory
26 Deeping St. James
Peterborough
PE8 8UD

Tel: 01778 346773
Fax: 01778 349151
Email: info@alstonscountryhomes.co.uk

Drawn	Check	TM
Drawn: MV	Check: TJM	

Project:
Proposed Development at Towngate West Market Deeping for Alston Country Homes

Drawings:
Proposed Site Layout Plan

Scale	1:500@A1	Date	06/04/10
Ref. Number	01	Rev.	E